

SUPERMASTER

Chain actuator - Force in push action 400 N - Stroke 450-600-800 mm



MAIN FEATURES

- The longest stroke (800 mm) and the highest force (400 N): it solves the problems to operate very heavy vents and the necessity of wide opening without taking up space inside the room (800 mm only for bottom hinged windows).
- Double link chain.
- Red led light placed on the actuator to signal the close position.

INSTALLATION REMARKS

- Minimum window height: 900 mm for 450 mm stroke, 1200 mm for 600 mm stroke, 1600 mm for 800 mm stroke.
- For windows without windowsill a fixing bracket (sliding within the dovetail slide) is available for an easy installation.
- In case of vents with four-bar hinges, please contact our Technical Dept.
- Supplied with 2 m cable (450-600 mm), 3 m cable (800 mm).
- For installation of two **SUPERMASTER AC** on the same vent it is available the Coupling Control unit CP230, part No. 41089V. (See CONTROL ACCESSORIES section)



24 Vdc version is suitable for installation on **Smoke and Heat Exhaust Ventilators (SHEV)** in conformity to European Standard **EN 12101-2**, tested by Istituto Giordano.



Stroke/force diagram

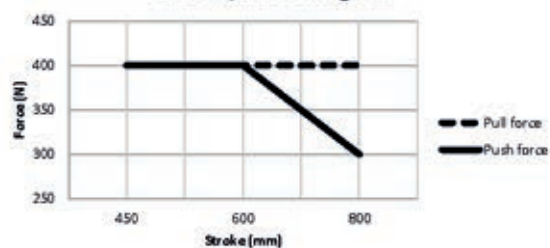

| | SUPERMASTER 230 V AC | | | SUPERMASTER 24 V DC | | |
|---|---------------------------------|---------------|---------------|---------------------------------|---------------|---------------|
| STROKE | 450 - 600 - 800 mm | | | 450 - 600 - 800 mm | | |
| VOLTAGE SUPPLY | 230 Vac \pm 10% | | | 24 Vdc \pm 10% | | |
| ELECTRIC CONNECTION | 3 wires + earth | | | 2 wires + signaling | | |
| OPERATION | - | | | by polarity inversion | | |
| FORCE (in push action) | 400 N (300 N for 800 mm stroke) | | | 400 N (300 N for 800 mm stroke) | | |
| FORCE (in pull action) | 400 N | | | 400 N | | |
| SPEED | ~23 mm/s | | | ~20 mm/s | | |
| CURRENT ABSORPTION (with max load) | 0,8 A | | | 2 A | | |
| PARALLEL CONNECTION | Yes | | | Yes | | |
| LIMIT STOP | Micro switches | | | Micro switches | | |
| SAFETY STOP | Thermic | | | Electronic | | |
| FEEDBACK SIGNAL | - | | | Open/Close | | |
| PROTECTION CLASS | IP20 | | | IP20 | | |
| PART No. | | | | | | |
| STROKE | 450 mm | 600 mm | 800 mm | 450 mm | 600 mm | 800 mm |
| SILVER ANODIZED | 40462T | 40452P | 40518U | 40506L | 40461R | 40469H |
| DARK BROWN ANODIZED | 40465Z | 40464X | 40753T | 40509T | 40467D | 40470S |
| WHITE PAINTED RAL 9010 | 40466B | 40454U | 40774O | 40507N | 40468F | 40471U |

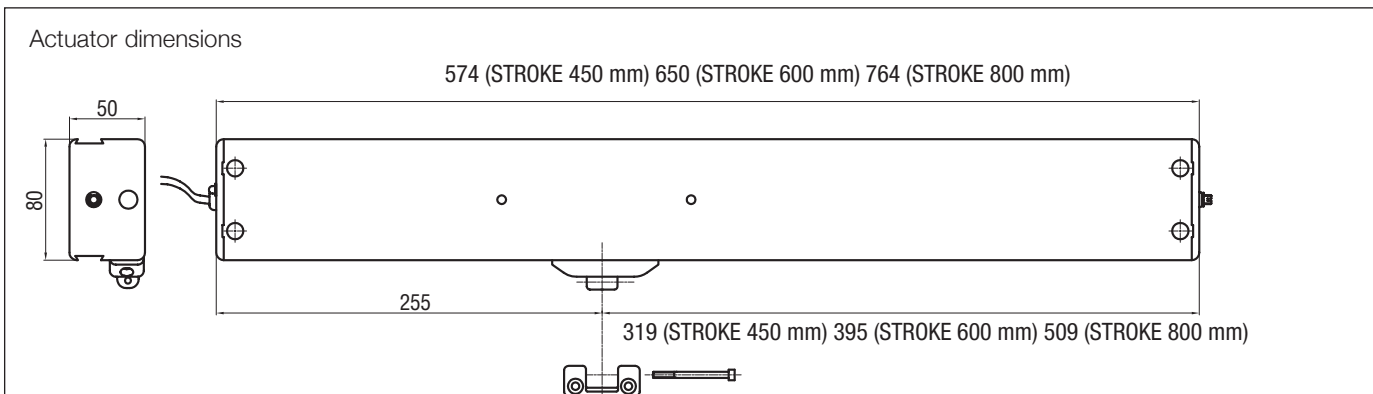
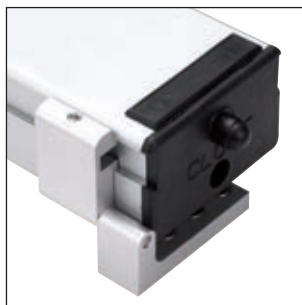

SPECIFICATION PROSPECTS

Electric chain actuator Ultraflex Control Systems named Supermaster with double link chain. Force 400 N. Strokes: 450-600-800 mm. Voltage supply 230 Vac or 24 Vdc. Limit stop by micro switches and thermal protection (230 Vac version) or electronic safety stop (24 Vdc version). Parallel connection. Casing in silver anodized or painted aluminium. The 230 Vac version and the 24 Vdc version are conform to 2004/108/CE directive, the 230 Vac version is also conform to 2006/95/CE.

Accessories

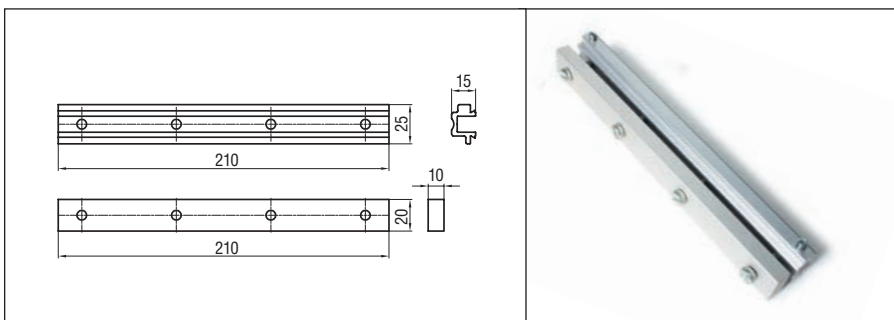

Sliding aluminium bracket with shim part No. 40460N

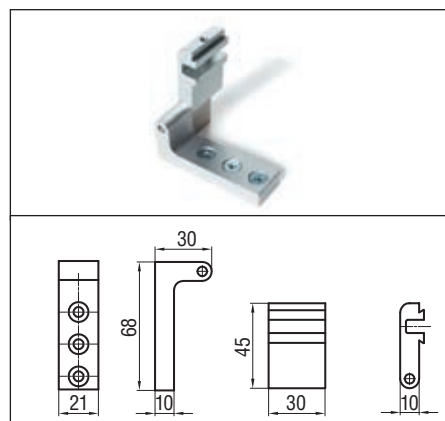

Pivoting brackets kit part No. 40560T

Installation examples



Top hinged windows



Side hinged windows



Roof windows

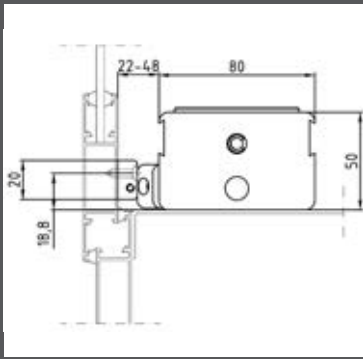

On windows with windowsill without brackets

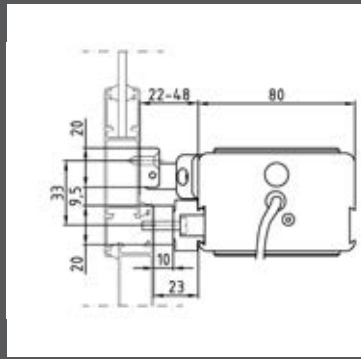

Without windowsill with bracket part No. 40460N

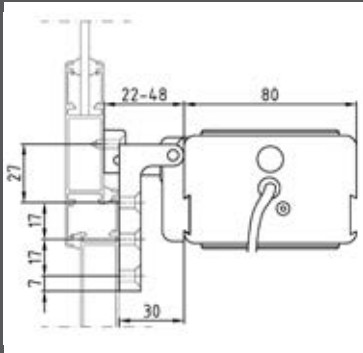

On the frame with pivoting brackets part No. 40560T

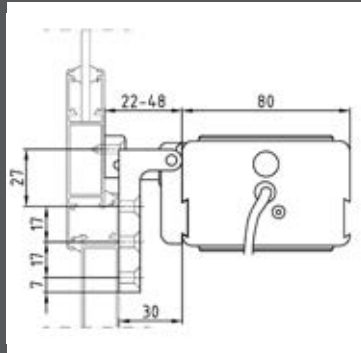

On windows with windowsill with pivoting brackets part No. 40560T

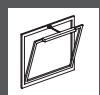

Bottom hinged windows



Side hinged windows

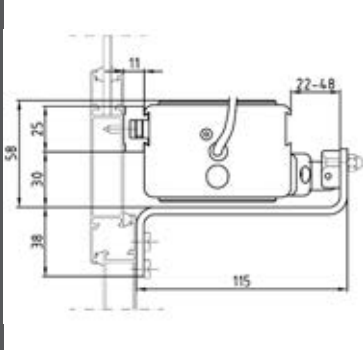

On the frame with bracket or bottom hinged window part No. 40472W

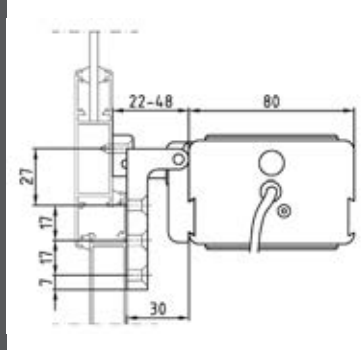

On the vent with the pivoting bracket part No. 40560T

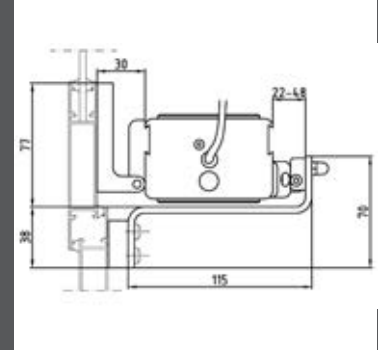

On the frame with the pivoting bracket part No. 40560T and bracket part No. 40472W

The instructions for a safe installation are included in the section "SECURITY WARNINGS"

Accessories

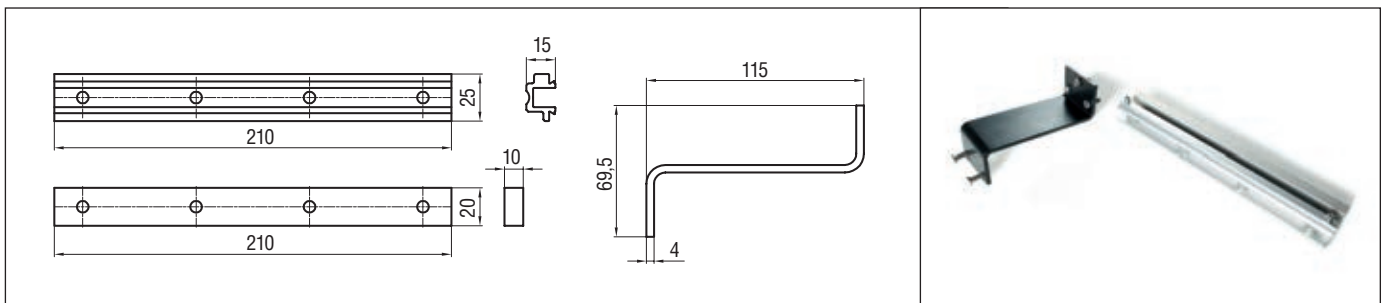

Sliding aluminium steel bracket with shim and bottom hinged painted steel bracket part No. 40472W

STILE

Chain actuator – Force 300 N – Stroke 400 mm



MAIN FEATURES

- Double link chain for a better load resistance in case of top hinged windows, heavy windows or roof windows.
 - Glass strengthened nylon casing.
 - Double electric insulation actuator (no electric connection to earth is needed).
 - The special removable plug allows a very quick and easy connection. It is ideal for the final test of the actuators on the building site.
 - Provided with closing feedback signal.
-
- **STILE** with selectable stroke 230/400 mm
 - **STILE R** with a maximum stroke of 400 mm, adjustable from 0 to 300 mm, by positioning a magnet on the chain during installation.
 - **STILE RF** with a selectable stroke 230/400 mm and integrated Radio Receiver. Radio Transmitter to be ordered separately-

INSTALLATION REMARKS

- Exclusive system for a quick and safe installation.
- Quick release system for an easy window cleaning.
- Supplied with pivoting brackets and spacer for chain connector to be used on windows with a high overlap.
- In case of vents with four-bar hinges, please contact our Technical Dept.
- For installation of two **STILE** on the same vent it is available the Coupling Control Unit CP230, part No. 41089V.
(See CONTROL ACCESSORIES section)



| | STILE | STILE R | STILE RF |
|-------------------------------|-----------------------|-------------------------------------|-----------------------|
| VOLTAGE SUPPLY | 230 Vac 50/80 Hz | 230 Vac 50/80 Hz | 230 Vac 50/80 Hz |
| ELECTRIC CONNECTION | 3 wires (*) | 3 wires (*) | 3 wires (*) |
| MAXIMUM STROKE | selectable 230/400 mm | 400 mm: adjustable from 0 to 300 mm | selectable 230/400 mm |
| FORCE | 300 N (**) | 300 N (**) | 300 N (**) |
| SPEED | ~30 mm/s | ~30 mm/s | ~30 mm/s |
| CURRENT ABSORPTION (max load) | 0,8 A | 0,8 A | 0,8 A |
| PARALLEL CONNECTION | Yes | Yes | Yes |
| LIMIT STOP | Micro switches | Micro switches/Hall sensor | Micro switches |
| PROTECTION | Thermic | Thermic | Thermic |
| FEEDBACK SIGNAL | Close | Close | Close |
| PROTECTION CLASS | IP20 | IP20 | IP20 |
| RADIO RECEIVER (integrated) | No | No | Yes |
| PART No. | | | |
| GRAY | 41554A | 41558E | 41730U |
| BLACK | 41555B | 41559F | 41731V |
| WHITE | 41556C | 41560G | 41732W |

(*) Double electric insulation actuator: no electric connection to earth is needed.

(**) In case of push action and full stroke, maximum force is intended for short period only

Installation examples



Top hinged windows



Side hinged windows



Roof windows

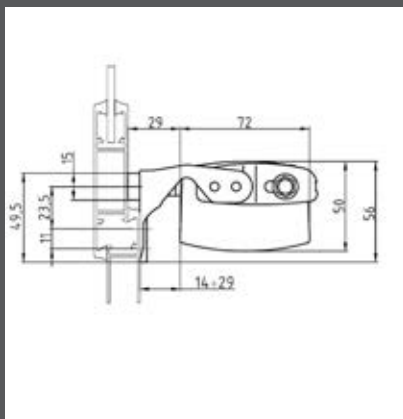

On the frame with pivoting brackets included

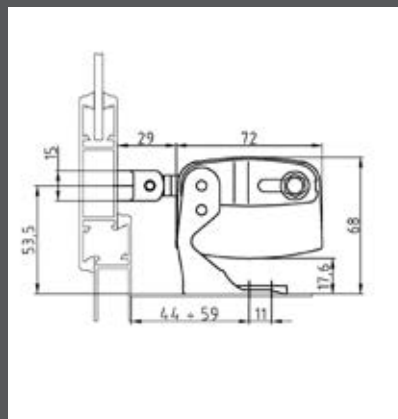

On the windowsill with pivoting brackets included

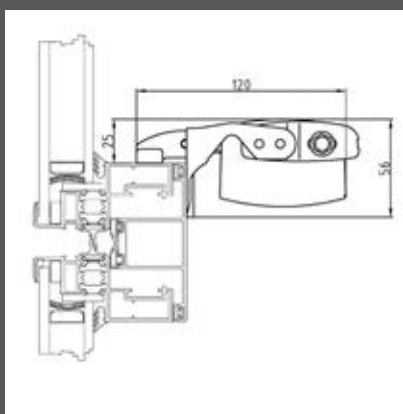

On the frame with pivoting brackets included and chain connector for concealed vents

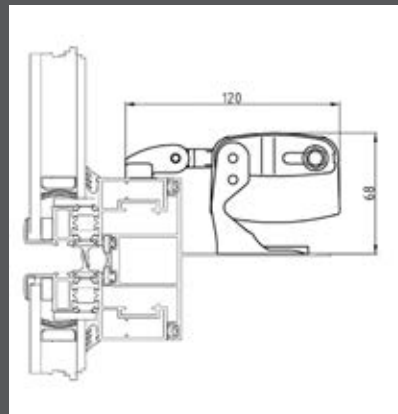

On the windowsill with pivoting brackets included and chain connector for concealed vents



Bottom hinged windows



Side hinged windows

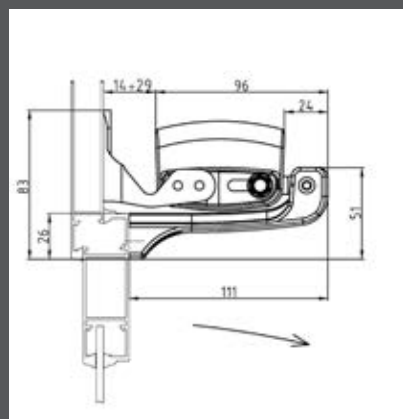

On the frame with pivoting brackets included and bottom hinged bracket

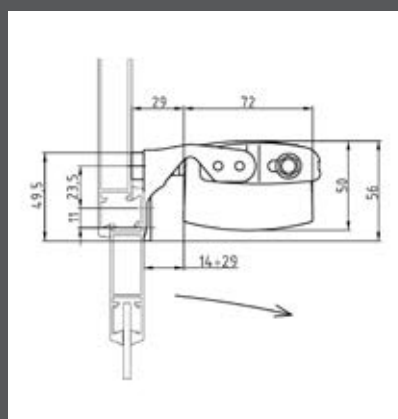

On the vent with pivoting brackets included

 The instructions for a safe installation are included in the section "SECURITY WARNINGS"

SPECIFICATION PROSPECT

Class 2 electric insulation chain actuator Ultraflex Control Systems named Stile with double link chain in two versions: selectable stroke 230/400 mm or adjustable stroke from 0 to 300 mm. Voltage supply: 230 Vac. Parallel connection. Limit stop by micro switches and thermal protection. Plastic scratch resistant finish.

NANO

Chain actuator - Force in push action 400 N - Maximum stroke 800 mm

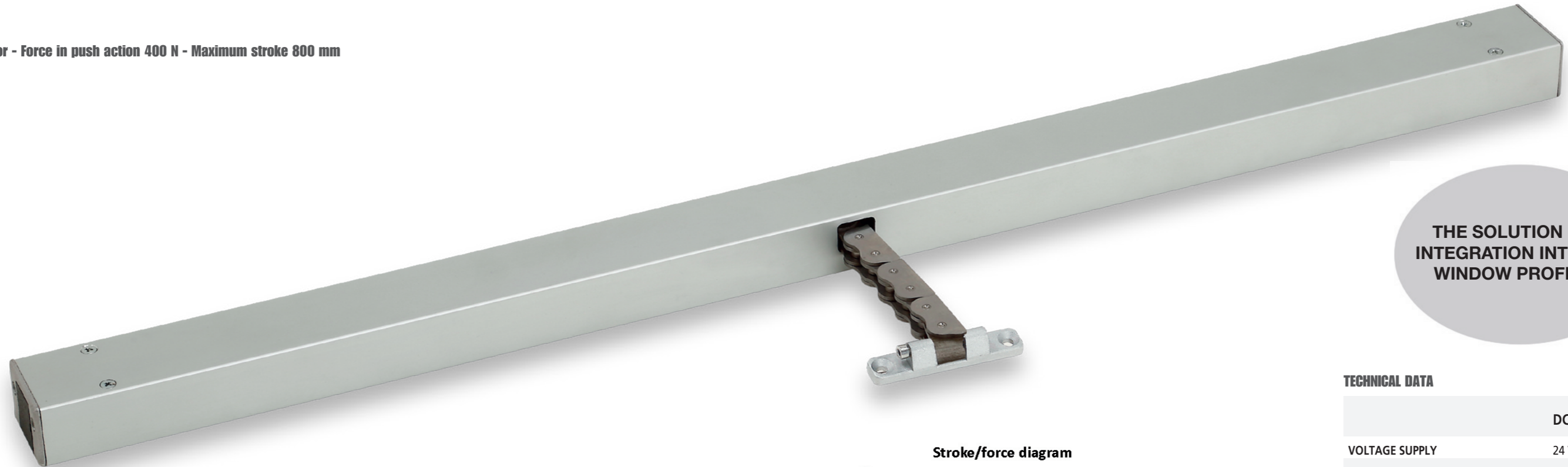

**THE SOLUTION FOR
INTEGRATION INTO THE
WINDOW PROFILES**

MAIN FEATURES

- The highest performance (400 N) in the smallest case (24 x 35 mm)
- Very silent operation
- Chain in double stainless steel links.
- Aluminum extrusion
- Electronic stop in the intermediate positions in case of overload.
- The **SYNCHRO NANO** versions are equipped with an integrated speed synchronization control board for the installation of more than one actuator on the same vent, avoiding any external control panel (max 4 actuators + E-Lock). SYNCHRO NANO versions provide also open/close feedback.
- The **SYNCHRO NANO F-SIGNAL** versions provide free potential opening and closing feedback signal (maintained contact), activated by the current limit.
- **NANO DC** is provided with 1,5 m cable (no synchronization, feedback signal and speed selection).
- Suitable for combined installation with the additional locking device E-LOCK (see related data sheet).
- Suitable for drawbridge application (Synchro versions).
- Soft stop in close and fully open position
- Reduction of entrapment risk: stop and reverse action in case of obstacle detected
- Cable connection on both sides (Synchro versions)

OTHER VERSIONS UPON REQUEST:

- **NANO** versions with **IP42** protection class, for a higher resistance against atmospheric agents.

- Versions for USA and Canada.

INSTALLATION REMARKS

- In case of vents with four-bar hinges, please contact our Technical Dept.
- If installed on PVC windows, the profile has to be reinforced.
- In case of Building Management System control, avoid repetitive commands in the same direction.

For further information contact our Tech. Dept.

Suitable for installation on **Smoke and Heat Exhaust Ventilators (SHEV)** in conformity to European Standard **EN 12101-2** (pending test).

The BMSline version is fully programmable (stroke, speed, force, ...); different scenarios are selectable with a connection to a computer through dedicated software. See BMSline section.

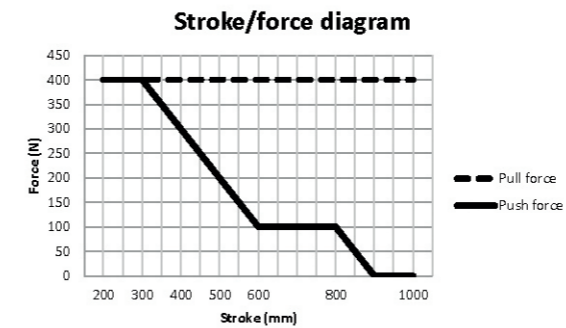

800 and 1000 mm stroke only for bottom hinged windows.

TECHNICAL DATA

| | DC VERSION |
|-------------------------------|--------------------|
| VOLTAGE SUPPLY | 24 Vdc ± 15% |
| CURRENT ABSORPTION (max load) | 1 A |
| OPERATION | polarity inversion |
| MAX FORCE | 400 N* |
| OPENING SPEED | 4 - 14 mm/s** |
| CLOSING SPEED | 4 mm/s |
| DUTY CYCLE | 30% |
| PARALLEL CONNECTION | Yes |
| LIMIT STOP | Electronic |
| SAFETY STOP | Electronic |
| PROTECTION CLASS | IP40 |

*Must be considered as a temporary load only, both in push and in pull.

**Silent operation: opening speed depending on stroke (minimum speed to complete the opening within 60 s). Synchro versions can provide Silent Ventilation (slower speed) activated by UCS C-SV Smoke Ventilation Control Panels.

Part No. for DC VERSIONS (24 Vdc ±15%)

| MODEL | SYNCHRO | FEEDBACK | CABLE | COLOUR | PART No. (Stroke) | | | | | |
|--------------------------|---------|------------------------------|---------------------|---|-------------------|---------------------|---|--------|--------|--------|
| NANO DC | - | - | 1,5 m 2 wires | SILVER ANODIZED BLACK RAL 9005 WHITE RAL 9010 | 200 mm | 300 mm | 400 mm | | | |
| | | | | | 41944Z | 41947C | 41950F | | | |
| | | | | | 41945A | 41948D | 41951G | | | |
| | | | | 41946B | 41949E | 41952H | | | | |
| | | | | 500 mm | 600 mm | 800 mm | | | | |
| | | | | 41953I | 41956L | 41959O | | | | |
| | | | SYNCHRO NANO DC | Yes | open/close | 8 pole connector | SILVER ANODIZED BLACK RAL 9005 WHITE RAL 9010 | 200 mm | 300 mm | 400 mm |
| | | | | | | | | 41962R | 41965U | 41968X |
| | | | | | | | | 41963S | 41966V | 41969Y |
| | | | | | | | 500 mm | 600 mm | 800 mm | |
| | | | | | | | 41971A | 41974D | 41977G | |
| | | | | | | | 41972B | 41975E | 41978H | |
| SYNCHRO NANO DC F-SIGNAL | Yes | free potential open/close | 8 pole connector | SILVER ANODIZED BLACK RAL 9005 WHITE RAL 9010 | 200 mm | 300 mm | 400 mm | | | |
| | | | | | 41981K | 41984N | 41987Q | | | |
| | | | | | 41982L | 41985O | 41988R | | | |
| | | | | 500 mm | 600 mm | 800 mm | | | | |
| | | | | 41989S | 41992V | 41995Y | | | | |
| | | | | 41990T | 41993W | 41996Z | | | | |
| | | | 41991U | 41994X | 41997A | | | | | |

NOTE: brackets, electrical connector and cable not included - to be ordered separately



Actuators dimensions

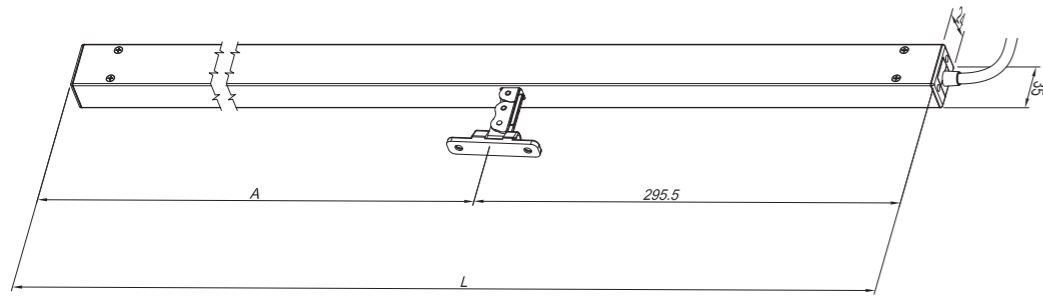

| STROKE | A (mm) | L (mm) |
|--------|--------|--------|
| 200 | 254,5 | 550 |
| 300 | 304,5 | 600 |
| 400 | 304,5 | 600 |
| 500 | 404,5 | 700 |
| 600 | 404,5 | 700 |
| 800 | 604,5 | 900 |
| 1000 | 604,5 | 900 |

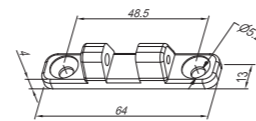

Connector included

Accessories - Electrical connectors and cables

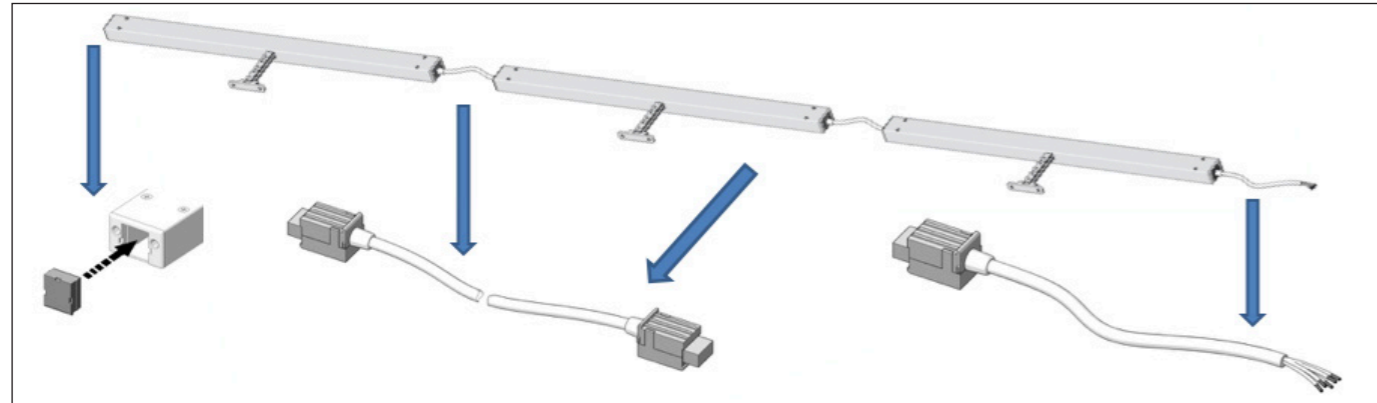

42016T Electrical Connector with 1,5 m cable (white) for SYNCHRO NANO DC

42021Y Electrical Connector (without cable) for SYNCHRO NANO DC and SYNCHRO NANO DC F-SIGNAL

42017U Electrical Connector with 1,5 m cable (black) for SYNCHRO NANO DC

42018V Cable with 2 connectors (1m, white) for installations of 2 x SYNCHRO NANO DC actuators.

42019W Electrical Connector (without cable)

Accessories - Brackets

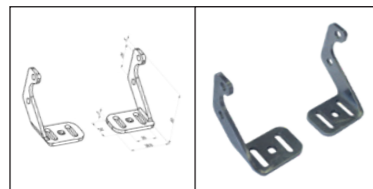

Front bracket kit:
GREY part no. 41935Q
BLACK part no. 41936R
WHITE part no. 41937S

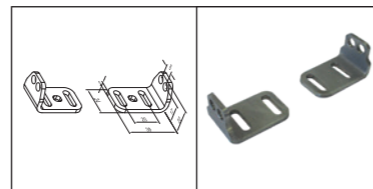

Back bracket kit:
GREY part no. 41932N
BLACK part no. 41933O
WHITE part no. 41934P

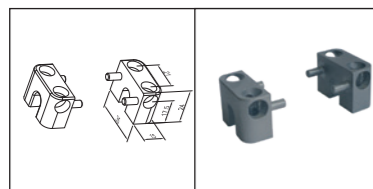

Side bracket kit:
GREY part no. 41938T
BLACK part no. 41939U
WHITE part no. 41940V

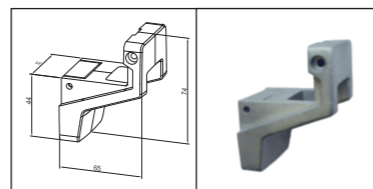

Aluminum bracket for bottom hinged windows:
GREY part no. 41941W
BLACK part no. 41942X
WHITE part no. 41943Y

Installation examples



Top hinged windows



Top hinged windows, two Synchro actuators

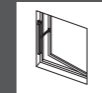

Side hinged windows



Roof windows



Parallel windows

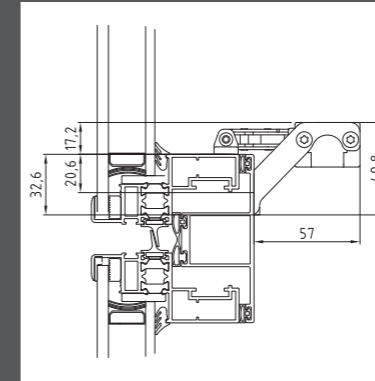

Concealed vent with front bracket

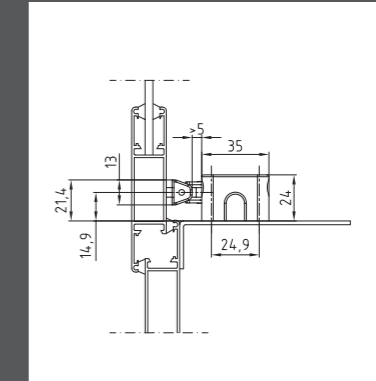

On windowsill with side brackets

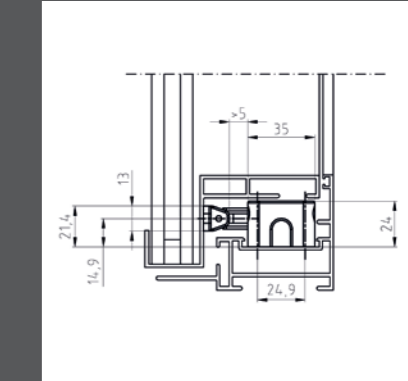

Integrated into window profiles with side brackets

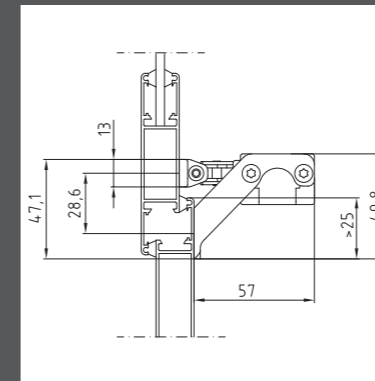

With front brackets

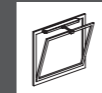

Bottom hinged windows

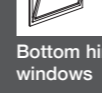

Side hinged windows

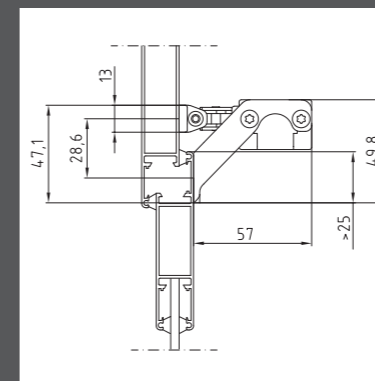

On the vent with front brackets

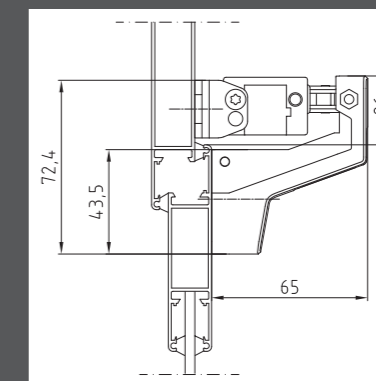

On the frame with back brackets and aluminum "Z" bracket

⚠ The instructions for a safe installation are included in the section "SECURITY WARNINGS"

SPECIFICATION PROSPECTS

Electric chain actuator Ultraflex Control Systems named Nano DC with chain in double stainless steel links. High performance (400 N) in very small case (24 x 35 mm). Voltage supply: 24 Vdc – Electronic limit stop; electronic stop in the intermediate positions in case of overload. Electric chain actuator Ultraflex Control Systems named Synchro Nano DC with chain in double stainless steel links. High performance (400 N) in very small case (24 x 35 mm). Voltage supply: 24 Vdc – Electronic limit stop; electronic stop in the intermediate positions in case of overload. Suitable for mounting more than one actuators (max 4 actuators) on the same vent: integrated speed synchronization. When "free potential open/close feedback" is required, indicate suffix "F-SIGNAL"



UCS
ULTRAFLEX CONTROL SYSTEMS Srl

Via XXV Aprile, 45
16012 Busalla (GE) - Italy
T +39 010 9768232 - F +39 010 9768233
ucs@ultraflexgroup.it
www.ucs.ultraflexgroup.it



**Window & Door
Accessories Ltd**

Window & Door Accessories Ltd
Window & Door Automation Specialists
Natural ventilation, Hybrid ventilation, Smoke ventilation
Facade Management Automation Equipment
Website: www.wdacc.ie E-mail: info@wdacc.ie

T-RACK

Linear rack actuators - Force in push action 1000/2000 N - Stroke 350, 550, 750 and 1000 mm



- 12 mm square rack transmission.
- Supplied with 1,5 m cable.
- Available end brackets or sliding brackets (to be ordered separately); the dovetail slide allows the fixing on the whole length of the T-Rack actuator.
- Available on request:
 - 1200 mm stroke
 - F-SIGNAL versions with opening and closing feedback signal (free potential, maintained contact), activated by the current limit.



24 Vdc version is suitable for installation on **Smoke and Heat Exhaust Ventilators (SHEV)** in conformity to European Standard **EN 12101-2** and tested by Istituto Giordano.

MULTIPLE SYSTEMS

- For large domes/top hinged windows or to provide more stability, the T-Rack actuator can be used in the **Dual T-Rack** version, providing two push points on the same vent. For each system assembly are necessary 1 T-Rack actuator, 1 T-Rack group, 1 connecting rod and 2 end fix brackets (part No. 41760Y)
- For large domes/top hinged windows that require double pushing force, coupled by connecting rods, **Double T-Rack** system is available. Please contact our Commercial Department.
- For special multiple application when speed synchronization or more power is required, max 4 actuators **Synchro T-Rack** can be used, each one providing 1000 N force. Synchro T-Rack version is equipped with an integrated speed synchronization control board, avoiding the installation of an external control box and metallic rod between the actuators.

CONNECTING ROD:

Diameter 12 mm in stainless steel. Quick clutch: fixing accessories are not necessary.
Available different lengths for following distance between racks:

| PART No. | |
|----------|--------|
| 1050 mm | 40231B |
| 1550 mm | 40232C |
| 2050 mm | 40233D |

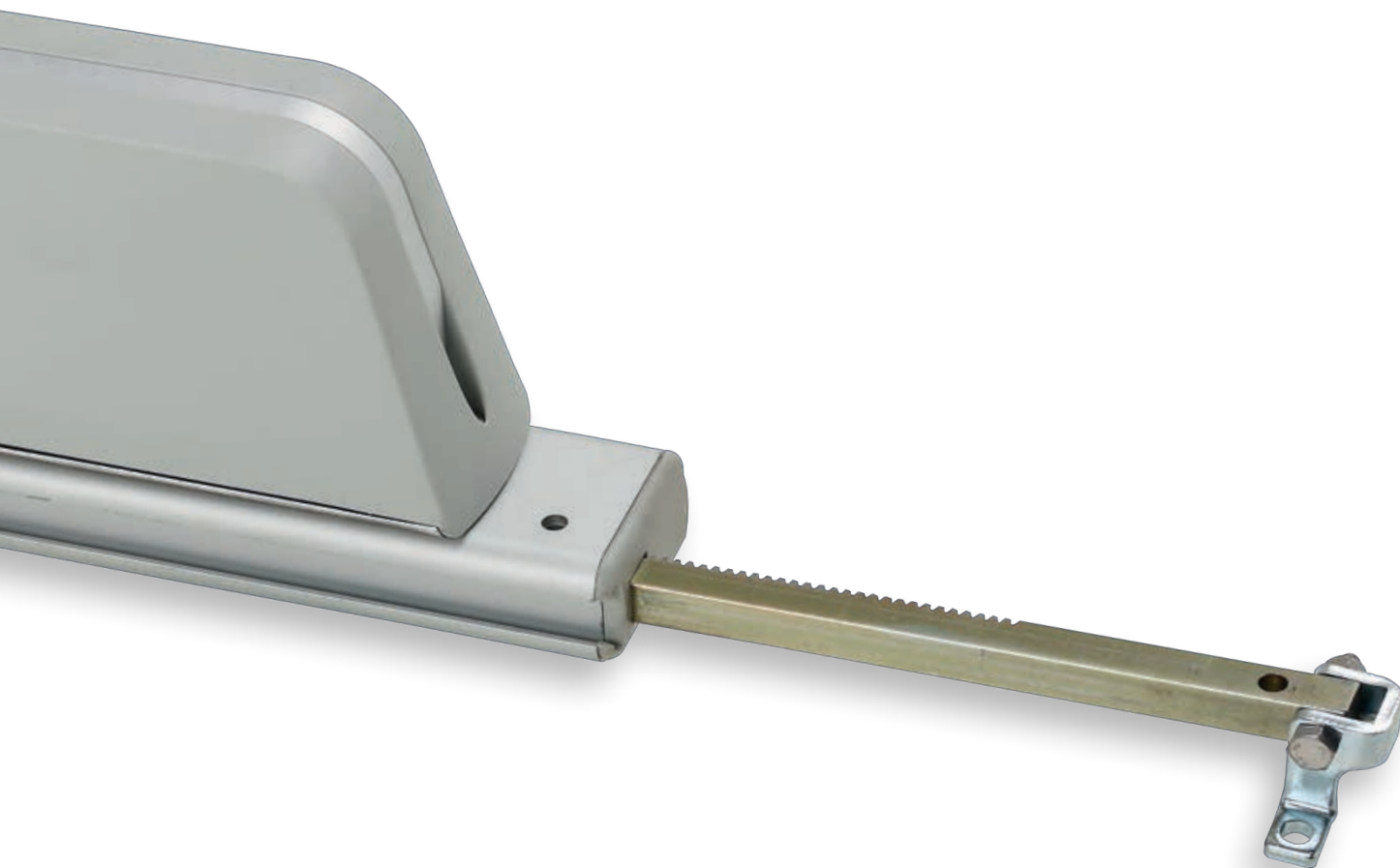

| | T-RACK 230 V AC | T-RACK 24 V DC | SYNCHRO T-RACK 24 V DC |
|------------------------------------|-----------------|-----------------------|------------------------|
| VOLTAGE SUPPLY | 230 Vca ± 10% | 24 Vdc ± 10% | 24 Vdc ± 10% |
| ELECTRIC CONNECTION | 3 wires + earth | 2 wires + signalling | 5 wires |
| OPERATION | - | by polarity inversion | by polarity inversion |
| FORCE IN PUSH ACTION | 1000 N | 1000 N | 1000 N |
| FORCE IN PULL ACTION | 1000 N | 1000 N | 1000 N |
| SPEED | ~12,5 mm/s | ~12,5 mm/s | ~12,5 mm/s |
| CURRENT ABSORPTION (with max load) | 0,22 A | 1,5 A | 1,5 A |
| PARALLEL CONNECTION | Yes | Yes | Yes |
| LIMIT STOP | Electronic | Electronic | Electronic |
| SAFETY STOP | Electronic | Electronic | Electronic |
| FEEDBACK SIGNAL | - | Open/Close | - |
| PROTECTION CLASS | IP65 | IP65 | IP65 |
| COLOUR | Silver anodized | Silver anodized | Silver anodized |

| PART No. | T-RACK GROUP | | | |
|----------------|--------------|--------|--------|--------|
| STROKE 350 mm | 41740E | 41745J | 41750O | 41755T |
| STROKE 550 mm | 41741F | 41746K | 41751P | 41756U |
| STROKE 750 mm | 41742G | 41747L | 41752Q | 41757V |
| STROKE 1000 mm | 41743H | 41748M | 41753R | 41758W |

NOTE: brackets not included - to be ordered separately

T-RACK



| STROKE | L |
|--------|------|
| 350 | 523 |
| 550 | 723 |
| 750 | 923 |
| 1000 | 1173 |

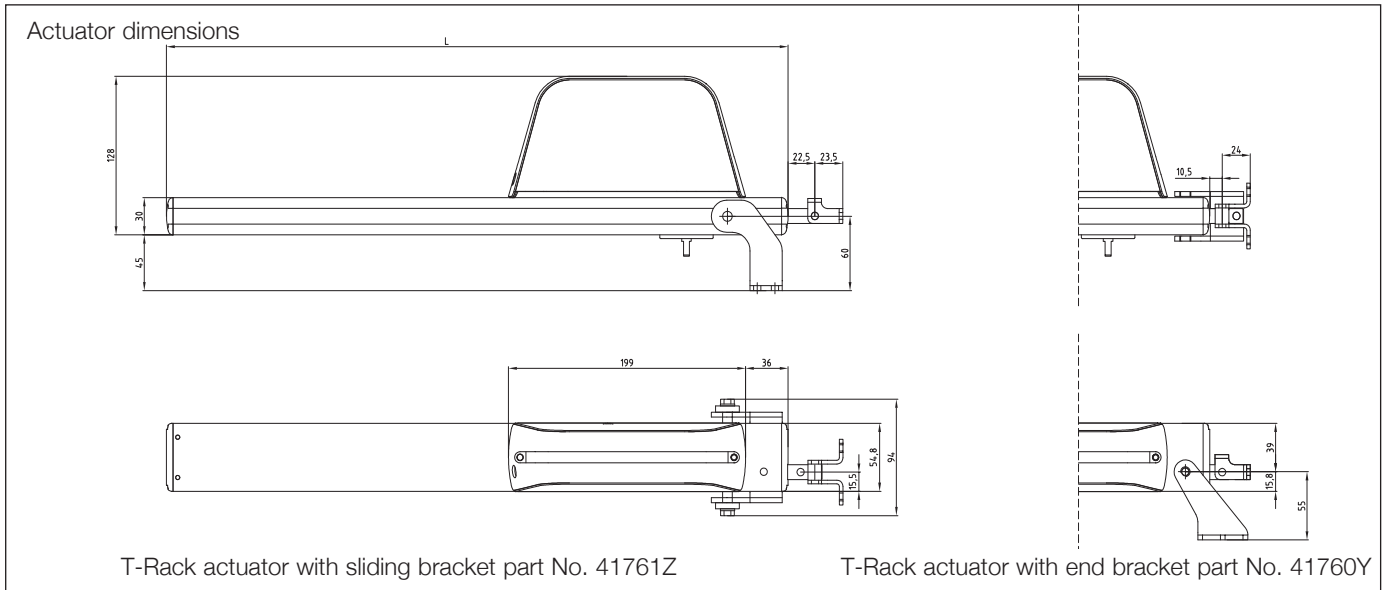

Accessories

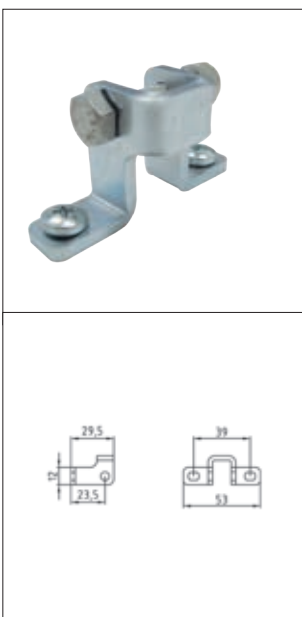

Connector kit to fix the rack to the vent (included)

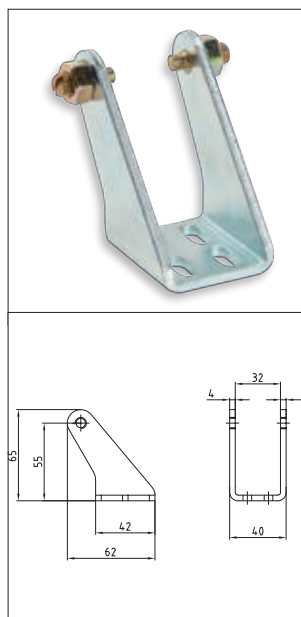

End bracket part No. 41760Y

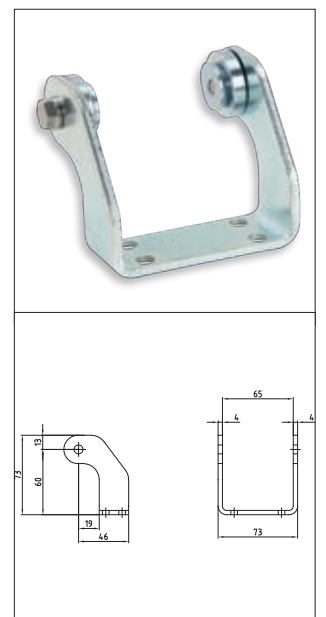

Sliding bracket part No. 41761Z

Installation examples



Installation on top hinged window

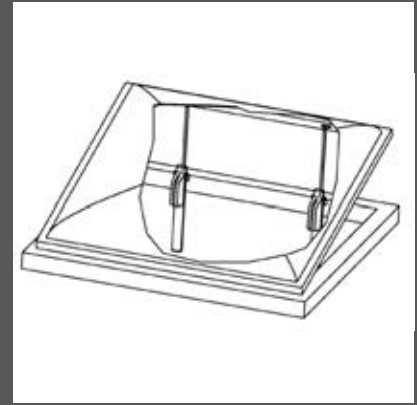

Installation on domes

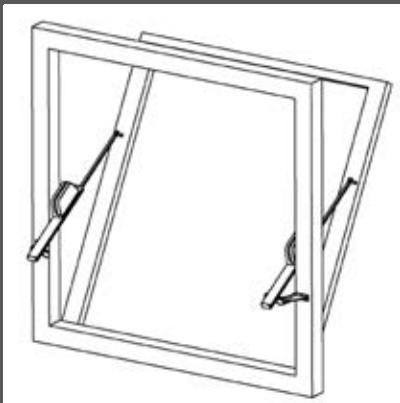

Installation on bottom hinged windows outward opening

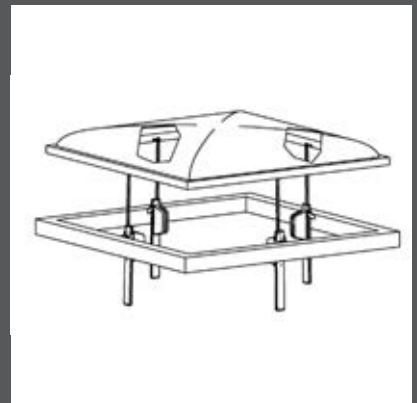

Installation on vertically opening domes

 The instructions for a safe installation are included in the section “SECURITY WARNINGS”

SPECIFICATION PROSPECTS

T-RACK

Electric linear actuator Ultraflex Control Systems. Available strokes 350, 550, 750 or 1000 mm. Voltage supply: 230 Vac or 24 Vdc. Electronic safety limit stop and electronic stop in the intermediate positions. Parallel connection. Color: silver anodized. Force 1000 N

DUAL T-RACK

System assembly with two push points composed by one T-Rack Actuator, one T-Rack Group and a connecting rod. Force 1000 N

DOUBLE T-RACK

System assembly with two push points composed by one T-RACK Actuator, one AUX T-RACK Actuator and a connecting rod. Force 2000N.

SYNCHRO T-RACK

Electric linear actuator Ultraflex Control Systems with integrated speed synchronization control board up to four push points on the same structure without connecting rod. Force 1000 N each actuator.

RACK

Linear rack actuators - Force in push action 650/1500 N - Stroke 180, 350, 550, 750 and 1000 mm

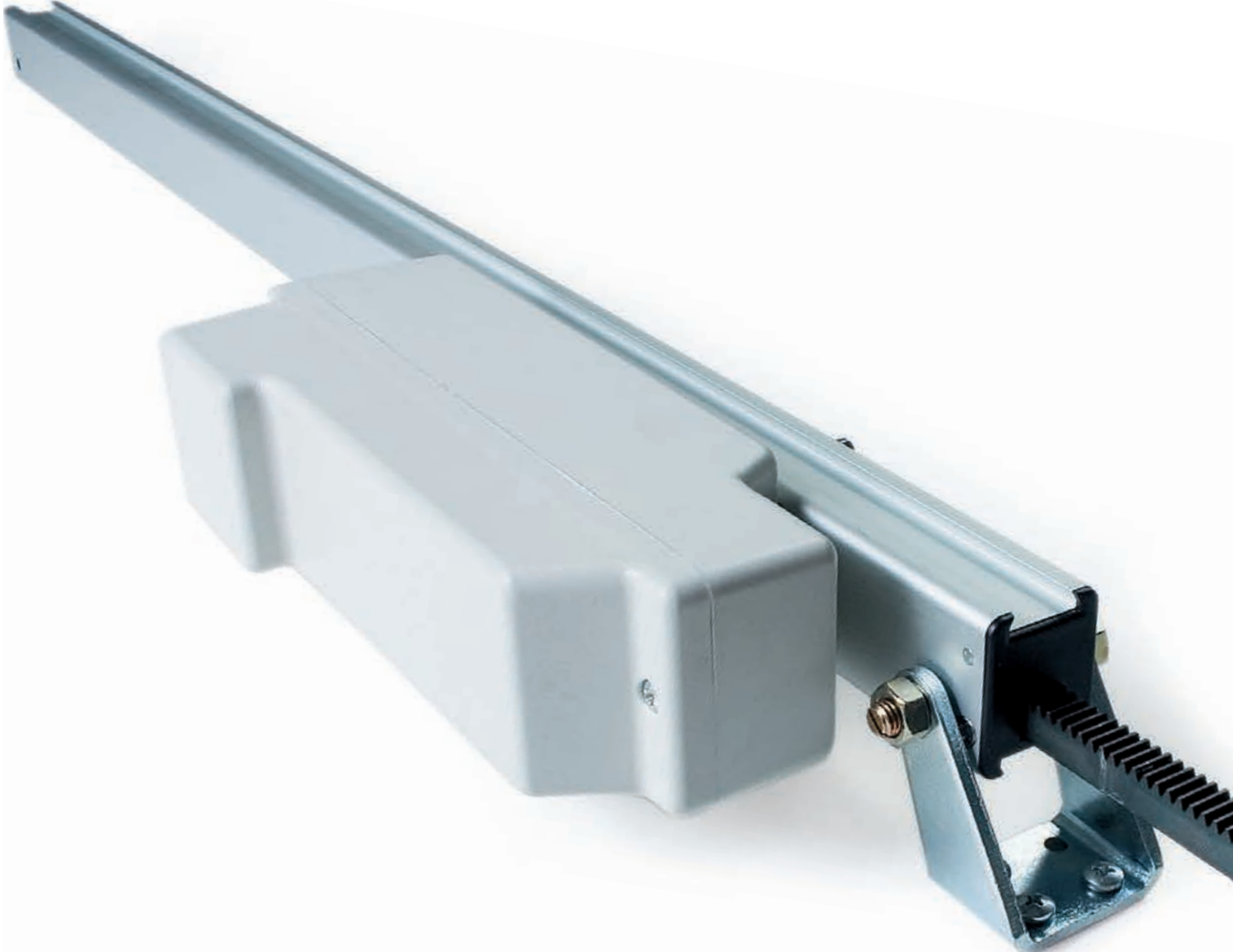

- 10 mm square rack transmission for stroke 180 mm, 350 mm, 550 mm and 12 mm square rack transmission for stroke 750 mm e 1000 mm.
- Supplied with 1,5 m cable.
- Available end brackets or sliding brackets (to be ordered separately); the dovetail slide allows the fixing on the whole length of the rack actuator. Not for multiple systems.



24 Vdc version is suitable for installation on **Smoke and Heat Exhaust Ventilators (SHEV)** in conformity to European Standard **EN 12101-2** and tested by Istituto Giordano.

MULTIPLE SYSTEMS

- For large domes/top hinged windows or to provide more stability, the Rack actuator can be used either in the **Dual Rack** or in the **Double Rack** version, providing two or more push points on the same vent. Double Rack provides the double of the force
- **Dual Rack:** push force 650 N (230 Vac) - 750 N (24 Vdc). For each system assembly are necessary 1 Rack actuator, 1 Rack group, 1 connecting rod and 2 end brackets (part No. 40234E see next page)
- **Double Rack:** push force 1300 N (230 Vac) - 1500 N (24 Vdc) For each system assembly are necessary 1 Rack actuator, 1 Auxiliary Rack actuator in parallel connection, 1 connecting rod and 2 end brackets (part No. 40234E see next page)
- **Other multiple systems:**

It is also available a Rack Group Double Pivot for system assembly providing 3 or more push points

| | RACK 230 V AC | RACK 24 V DC |
|------------------------------------|-------------------|-----------------------|
| VOLTAGE SUPPLY | 230 Vac \pm 10% | 24 Vdc \pm 10% |
| ELECTRONIC CONNECTION | 3 wires + earth | 2 wires + signalling |
| OPERATION | - | by polarity inversion |
| FORCE IN PUSH ACTION | 650 N | 750 N |
| FORCE IN PULL ACTION | 350 N | 650 N |
| SPEED | \sim 8 mm/s | \sim 8 mm/s |
| CURRENT ABSORPTION (with max load) | 0,1 A | 1 A |
| PARALLEL CONNECTION | Yes | Yes |
| LIMIT STOP | Electronic | Electronic |
| SAFETY STOP | Electronic | Electronic |
| FEEDBACK SIGNAL | - | Open/Close |
| PROTECTION CLASS | IP55 | IP55 |
| COLOUR | Silver anodized | Silver anodized |

| PART No. | | |
|----------------|--------|--------|
| STROKE 180 mm | 40209F | 40400A |
| STROKE 350 mm | 40211T | 40217D |
| STROKE 550 mm | 40213V | 40219H |
| STROKE 750 mm | 40789D | 40791F |
| STROKE 1000 mm | 40790E | 40792G |

| PART No. | RACK GROUP | RACK GROUP DOUBLE PIVOT | AUXILIARY RACK 230 VAC | AUXILIARY RACK 24 VDC |
|----------------|------------|-------------------------|------------------------|-----------------------|
| STROKE 180 mm | 40223B | 40379W | 40631P | 40636A |
| STROKE 350 mm | 40225D | 40380U | 40632S | 40637C |
| STROKE 550 mm | 40227F | 40381V | 40633U | 40638E |
| STROKE 750 mm | 40754U | 40851N | 40847J | 40849L |
| STROKE 1000 mm | 40755V | 40852O | 40848K | 40850M |

CONNECTING ROD:

Diameter 12 mm in stainless steel. Quick clutch: fixing accessories are not necessary. Available different lengths for following distance between racks:

| PART No. | |
|----------|--------|
| 1000 mm | 40231B |
| 1500 mm | 40232C |
| 2000 mm | 40233D |

NOTE: brackets not included - to be ordered separately

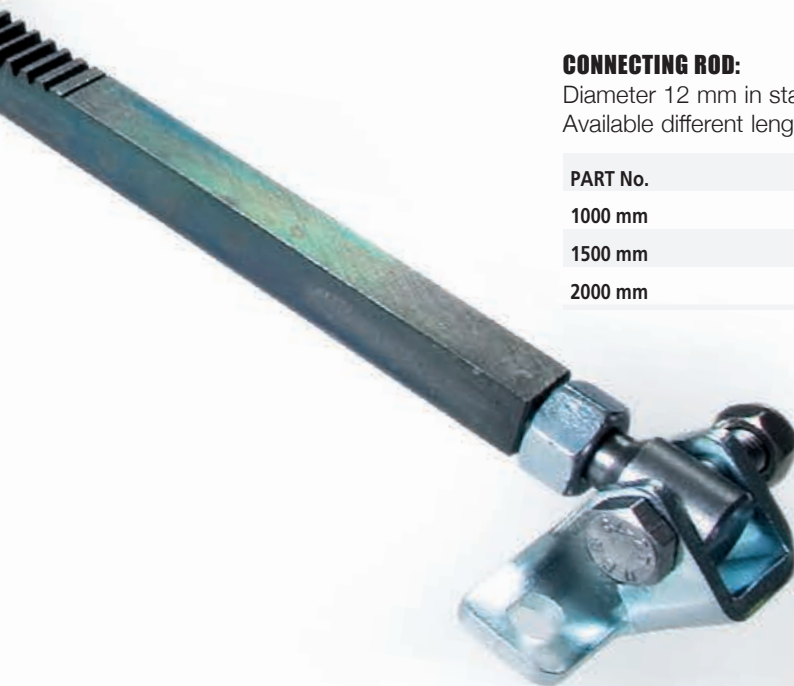

RACK, DUAL RACK and DOUBLE-RACK

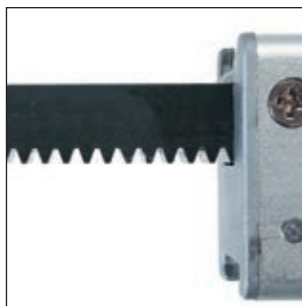

| STROKE | A |
|--------|------|
| 180 | 400 |
| 350 | 570 |
| 550 | 770 |
| 750 | 970 |
| 1000 | 1220 |

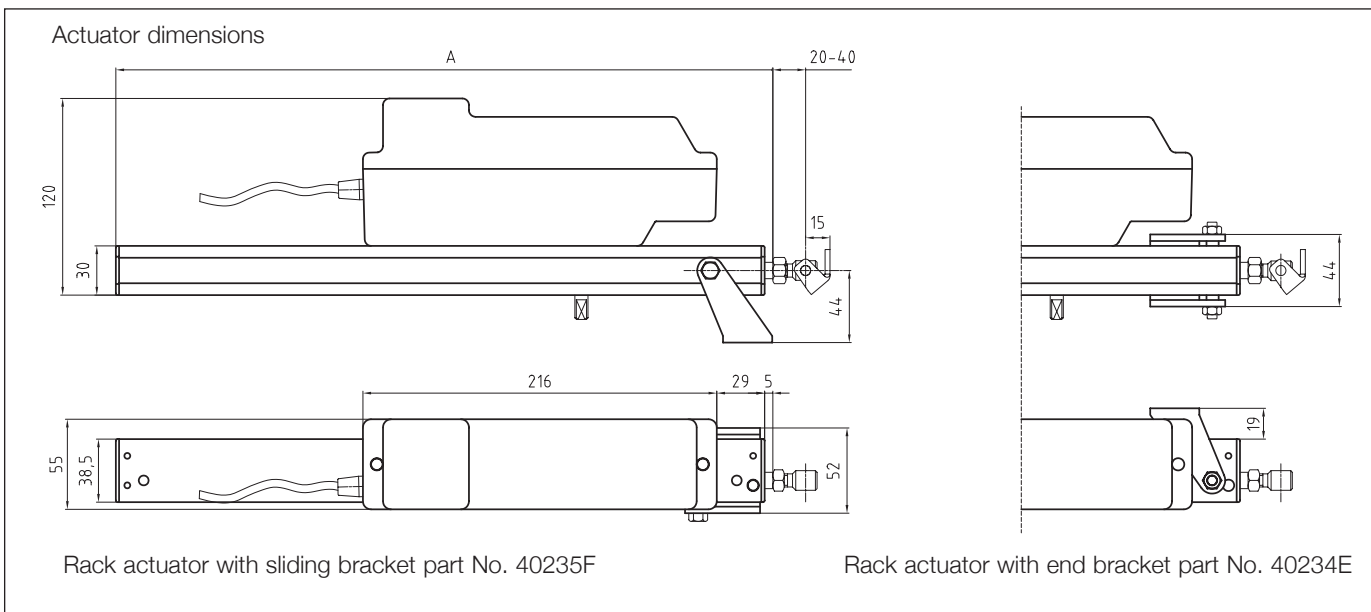

Accessories

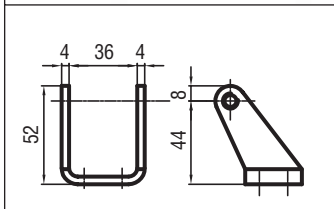
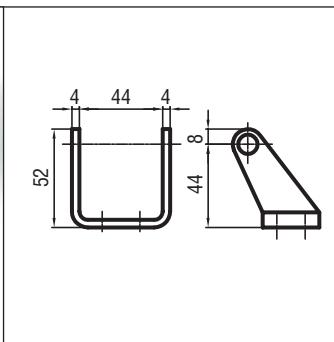

Sliding bracket part No. 40235F. It allows the fixing for the whole length of the actuator. To use only for single Rack.

Connector kit to fix the rack on the vent (included)

End bracket part No. 40234E. To use for Dual Rack and Double Rack system or single Rack.

Installation examples

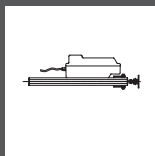

Single Rack

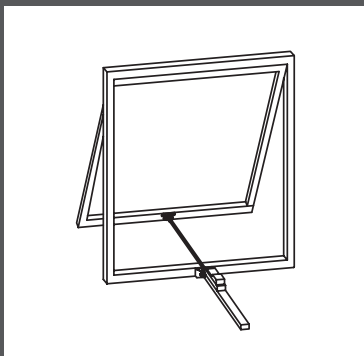

On top hinged window without windowsill with front fixing through sliding bracket part No. 40235F

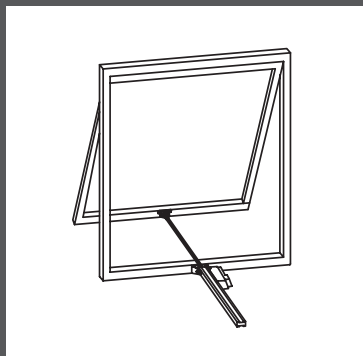

On top hinged window without windowsill with front fixing through end bracket part No. 40234E

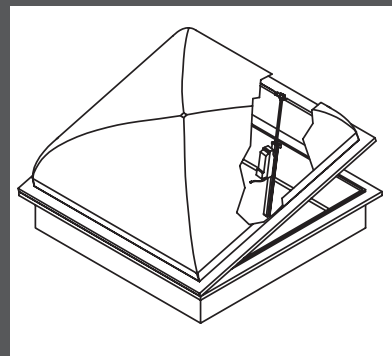

On domes with front fixing through sliding bracket part No. 40235F

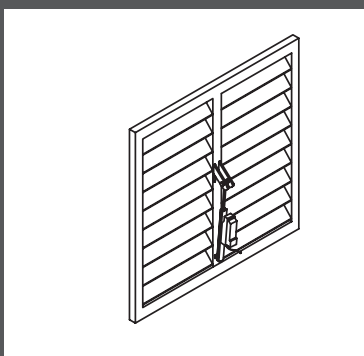

On horizontal louvers with back fixing through sliding bracket part No. 40235F

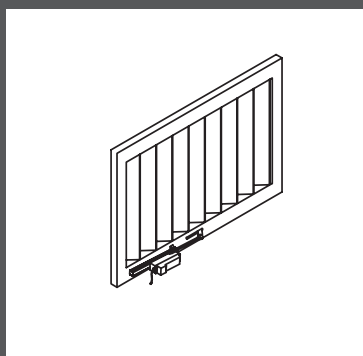

On vertical sun blades with back fixing through sliding bracket part No. 40235F

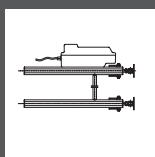

Dual Rack

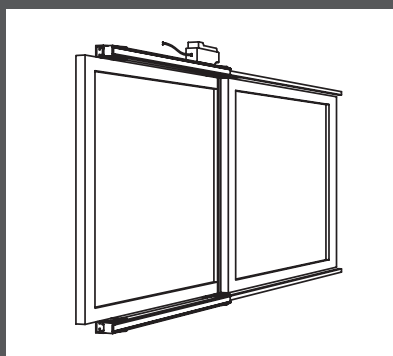

Installation of the Dual Rack on sliding windows with end bracket part No. 40234E and connection of the two actuators through rod

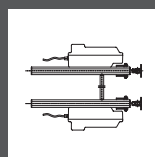

Double Rack

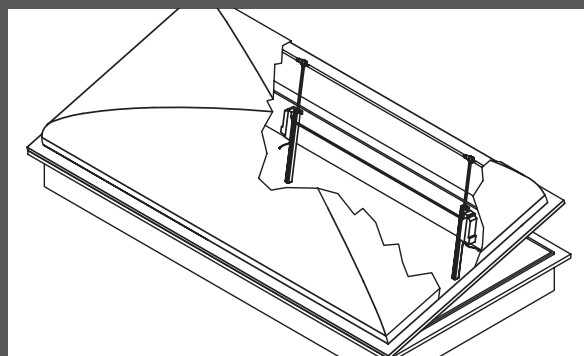

Installation of the Double Rack on domes with end bracket part No. 40234E and connection of the two actuators through rod

 The instructions for a safe installation are included in the section "SECURITY WARNINGS"

SPECIFICATION PROSPECTS

RACK
Electric linear actuator Ultraflex Control Systems. Available strokes 180, 350, 550, 750 or 1000 mm. Voltage supply: 230 Vac or 24 Vdc. Electronic safety limit stop and electronic stop in the intermediate positions. Parallel connection. Color: silver anodized. Force 650 N/750 N

DUAL RACK

System assembly with two push points composed by one Rack Actuator, one Rack Group and a connecting rod. Force 650 N/750 N

DOUBLE RACK

System assembly with two push points composed by one Rack Actuator, one auxiliary Rack and a connecting rod. Force 1300 N/1500 N.
Systems with more than two push points can be obtained with a Rack Group double pivot.



UCS
ULTRAFLEX CONTROL SYSTEMS Srl

Via XXV Aprile, 45
16012 Busalla (GE) - Italy
T +39 010 9768232 - F +39 010 9768233
ucs@ultraflexgroup.it
www.ucs.ultraflexgroup.it



**Window & Door
Accessories Ltd**

Window & Door Accessories Ltd
Window & Door Automation Specialists
Natural ventilation, Hybrid ventilation, Smoke ventilation
Facade Management Automation Equipment
Website: www.wdacc.ie E-mail: info@wdacc.ie